

NOTES

1. THIS DRAWING IS THE PROPERTY OF JACOBS AND IS NOT TO BE REPRODUCED OR TRANSMITTED IN ANY FORM OR BY ANY MEANS, ELECTRONIC OR MECHANICAL, WITHOUT THE WRITTEN PERMISSION OF JACOBS.
2. THE USER OF THIS DRAWING SHALL BE RESPONSIBLE FOR OBTAINING ALL NECESSARY PERMITS AND APPROVALS FROM THE APPROPRIATE AUTHORITIES.
3. THE USER OF THIS DRAWING SHALL BE RESPONSIBLE FOR OBTAINING ALL NECESSARY PERMITS AND APPROVALS FROM THE APPROPRIATE AUTHORITIES.
4. THE USER OF THIS DRAWING SHALL BE RESPONSIBLE FOR OBTAINING ALL NECESSARY PERMITS AND APPROVALS FROM THE APPROPRIATE AUTHORITIES.
5. THE USER OF THIS DRAWING SHALL BE RESPONSIBLE FOR OBTAINING ALL NECESSARY PERMITS AND APPROVALS FROM THE APPROPRIATE AUTHORITIES.

REFERENCED DRAWINGS

NO.	DESCRIPTION	DATE
1	PROPOSED SIGNAGE PLAN - EMERGENCY DEPARTMENT ARRIVAL	20/05/2024
2	PROPOSED SIGNAGE PLAN - EMERGENCY DEPARTMENT ARRIVAL	20/05/2024
3	PROPOSED SIGNAGE PLAN - EMERGENCY DEPARTMENT ARRIVAL	20/05/2024
4	PROPOSED SIGNAGE PLAN - EMERGENCY DEPARTMENT ARRIVAL	20/05/2024
5	PROPOSED SIGNAGE PLAN - EMERGENCY DEPARTMENT ARRIVAL	20/05/2024
6	PROPOSED SIGNAGE PLAN - EMERGENCY DEPARTMENT ARRIVAL	20/05/2024
7	PROPOSED SIGNAGE PLAN - EMERGENCY DEPARTMENT ARRIVAL	20/05/2024
8	PROPOSED SIGNAGE PLAN - EMERGENCY DEPARTMENT ARRIVAL	20/05/2024
9	PROPOSED SIGNAGE PLAN - EMERGENCY DEPARTMENT ARRIVAL	20/05/2024
10	PROPOSED SIGNAGE PLAN - EMERGENCY DEPARTMENT ARRIVAL	20/05/2024

KEY PLAN

NO.	DESCRIPTION	DATE
1	PROPOSED SIGNAGE PLAN - EMERGENCY DEPARTMENT ARRIVAL	20/05/2024
2	PROPOSED SIGNAGE PLAN - EMERGENCY DEPARTMENT ARRIVAL	20/05/2024
3	PROPOSED SIGNAGE PLAN - EMERGENCY DEPARTMENT ARRIVAL	20/05/2024
4	PROPOSED SIGNAGE PLAN - EMERGENCY DEPARTMENT ARRIVAL	20/05/2024
5	PROPOSED SIGNAGE PLAN - EMERGENCY DEPARTMENT ARRIVAL	20/05/2024
6	PROPOSED SIGNAGE PLAN - EMERGENCY DEPARTMENT ARRIVAL	20/05/2024
7	PROPOSED SIGNAGE PLAN - EMERGENCY DEPARTMENT ARRIVAL	20/05/2024
8	PROPOSED SIGNAGE PLAN - EMERGENCY DEPARTMENT ARRIVAL	20/05/2024
9	PROPOSED SIGNAGE PLAN - EMERGENCY DEPARTMENT ARRIVAL	20/05/2024
10	PROPOSED SIGNAGE PLAN - EMERGENCY DEPARTMENT ARRIVAL	20/05/2024

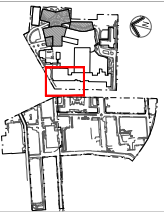

PROJECT MANAGER
TSA

CLIENT
Health
NSW Local Health District
Health
NSW Infrastructure
CPB

ARCHITECT
JACOBS
BATESSMART
NIESEN MAJICOTT + NELLE

PROJECT
ROYAL PRINCE ALBERT HOSPITAL
RECONSTRUCTION

TTW
Structural
Traffic
Facade

DRAWING TITLE
MW - LINEMARKING AND SIGNAGE PLAN - EMERGENCY DEPARTMENT ARRIVAL

STATUS
APPROVED FOR CONSTRUCTION

DRAWN
WW

CHECKED
TD

SCALE @ B1
1:100

DRAWING NO.
RPA-CIV-TTW/ORG-MW-012334

REVISION
01

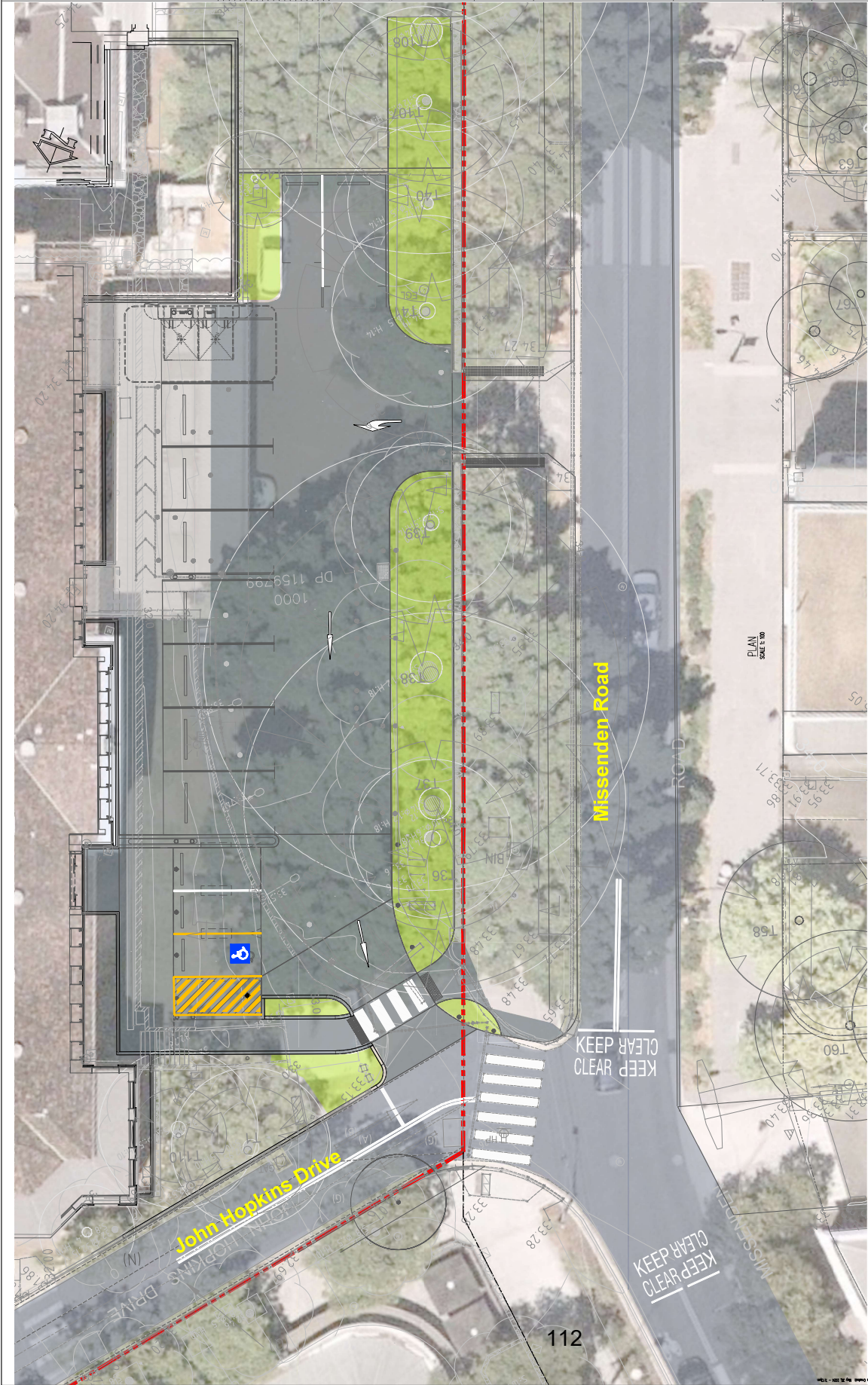

THICKNESS
LINE
TEXT
DIMENSION
HATCH
BORDER
SCALE

SCALE 1:100
0 1 2 3 4 5
AT ORIGINAL SIZE